

# DENON®

## DHT-S316

HOME THEATER SYSTEM

# Quick Start Guide

Guide de démarrage rapide / Guía de inicio rápido

## Read Me First....

Lisez-moi en premier.... / Lea esto primero....

ENGLISH

FRANÇAIS

ESPAÑOL

# Welcome

Thank you for choosing a Denon TV Sound system.  
This guide provides step-by-step instructions for setting up  
your TV Sound system.

# Before You Begin

## What You Need

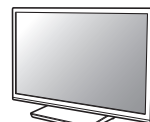

TV



- These drawings are for illustrative purposes only and may not represent the actual product(s).

# What's In the Box

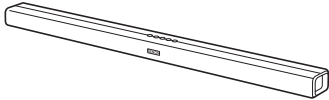

Soundbar



Subwoofer



Quick Start Guide

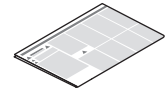

Safety Instructions

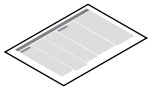

Notes on radio



Warranty

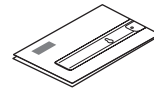

Wall mount template



Power cords

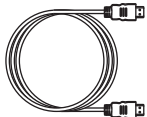

HDMI cable

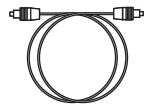

Optical digital cable



Wall mount spacers



Remote control unit  
(RC-1230)



R03/AAA battery

## Installing batteries in the remote control unit

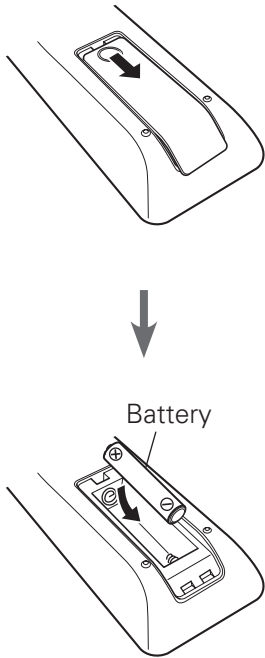

# Setup

There are six steps to the setup process.

- 1** Placing the Soundbar
- 2** Placing the Subwoofer
- 3** Connecting the Soundbar to TV
- 4** Connecting the power cords to AC outlet
- 5** Using the Soundbar for TV sound
- 6** Using the Soundbar for Bluetooth music streaming

# 1 Placing the Soundbar

Place the Soundbar in front of the TV.

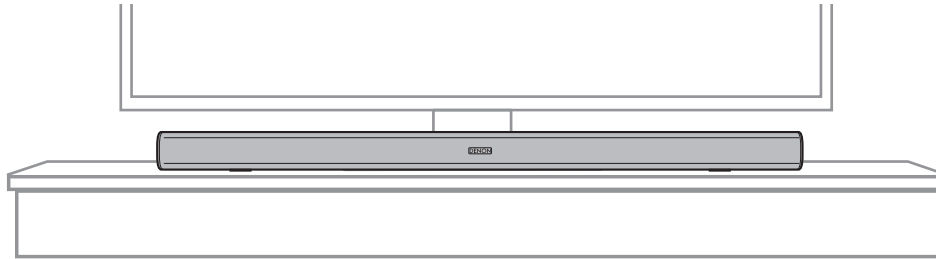

- The Soundbar can be wall-mounted using the integrated keyhole mounts. Refer to the wall mount template in the PE bag which contains multiple documents. (Same as this Quick Start Guide bag.)
- If you want to install your Soundbar on a wall, please refer to the Owner's Manual for mounting instructions or contact your Denon dealer for assistance.

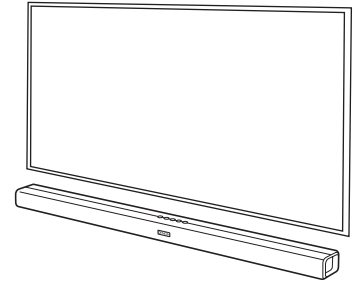

## 2 Placing the Subwoofer

Place the Subwoofer on the floor near the Soundbar.

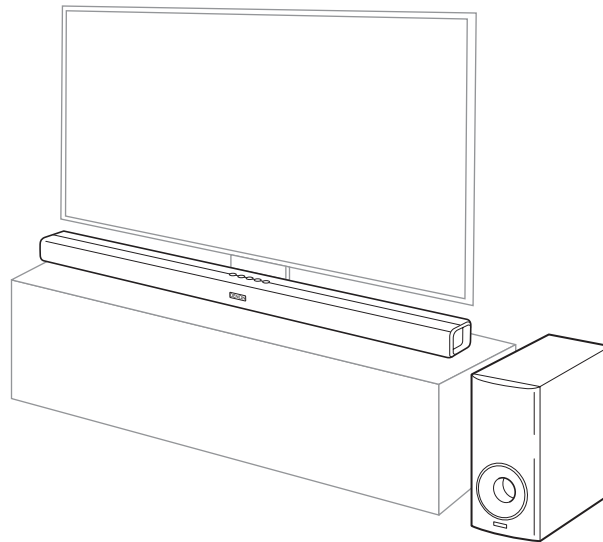

### 3 Connecting the Soundbar to TV

For TVs with ARC (Audio Return Channel) support, connect the Soundbar to the TV with the included HDMI cable.

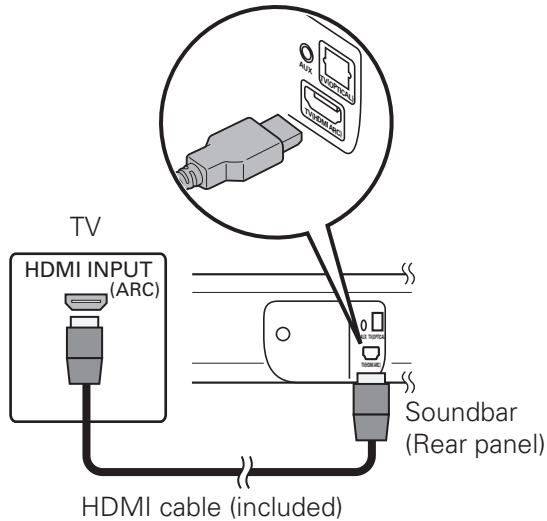

- If the TV does not support ARC, connect it to the Soundbar using the included HDMI cable and optical digital cable.

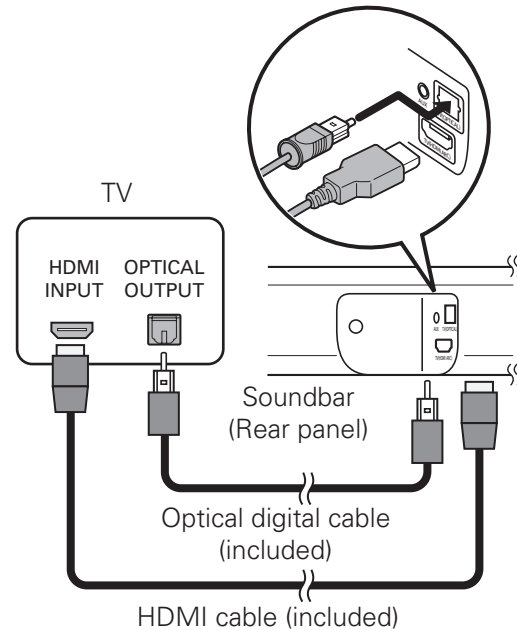

## 4 Connecting the power cords to AC outlet

Connect the included power supply cords to the Soundbar and Subwoofer, and insert the plugs into an outlet.

- Turn on the Soundbar and the LED on the back of the Subwoofer will change from off to green.

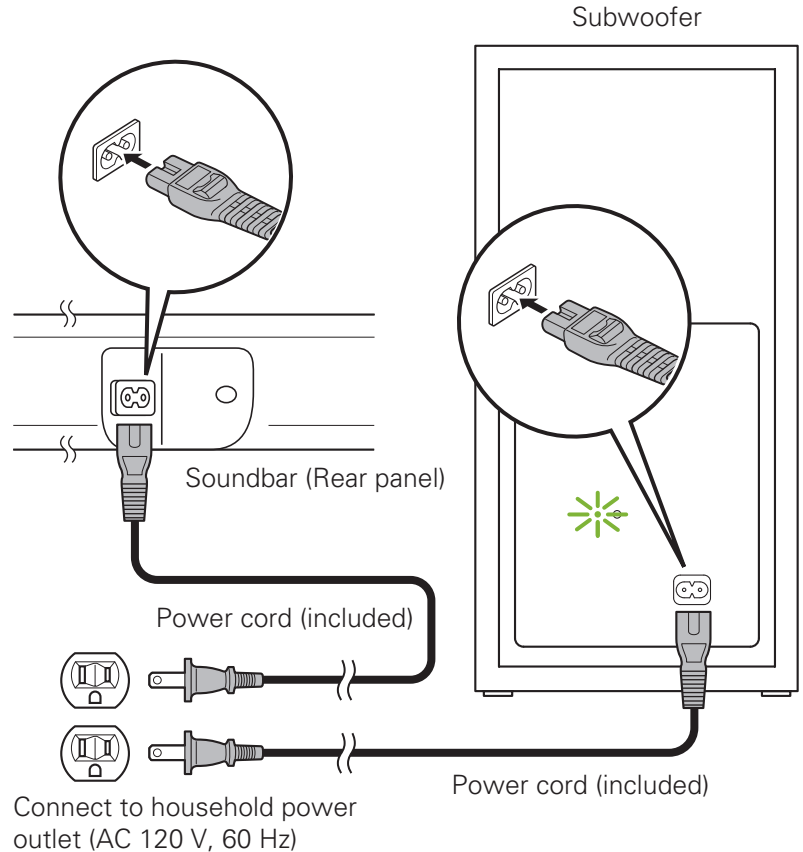



## 5 Using the Soundbar for TV sound

Turn on your TV.



- If you hear audio coming from TV's internal speaker, make sure TV speaker off or min volume.

## 6 Using the Soundbar for Bluetooth music streaming

Before you can stream music from your Bluetooth device to the Soundbar, you must first “pair” the Soundbar and your device.

- ① Press the ⌘ (Bluetooth) button on the Soundbar (or remote control unit) until the Bluetooth LED blinks in blue.  
To pair additional devices, press and hold the ⌘ (Bluetooth) button to automatically enter pairing mode.
- ② Go to the Bluetooth settings on your device and make sure Bluetooth is turned ON.
- ③ Select “DHT-S316”.
  - The Bluetooth LED turns blue to indicate that the Soundbar is being paired with your Bluetooth device.

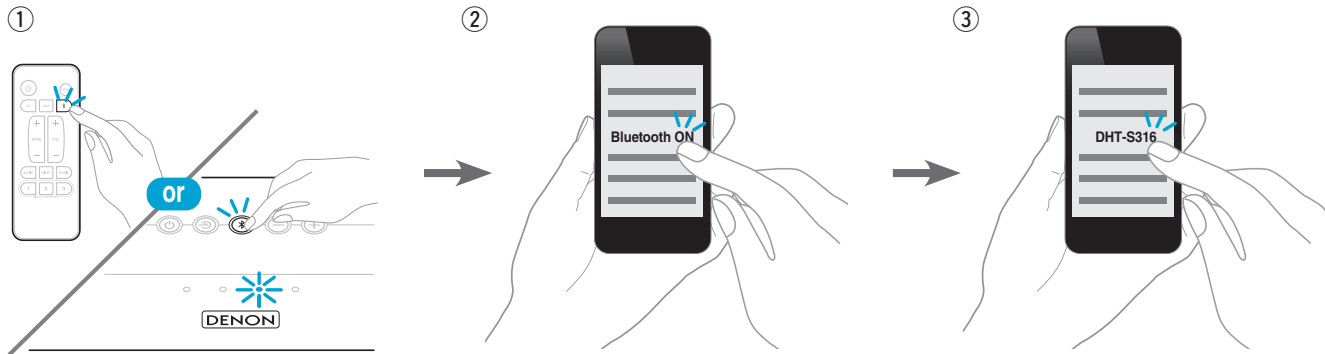

# Owner's Manual

- For more information, visit [www.denon.com](http://www.denon.com)
- Refer to the Online Manual for other functions information and operation procedure details.  
[manuals.denon.com/DHTS316/NA/EN/](http://manuals.denon.com/DHTS316/NA/EN/)

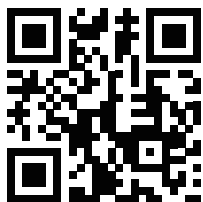

Online Manual

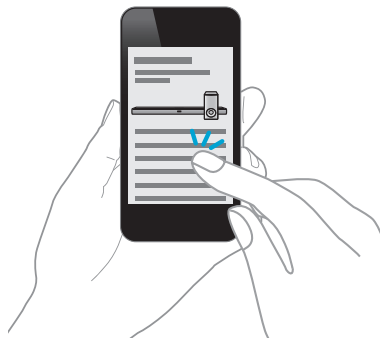

**DENON®**  
www.denon.com

Printed in China 5411 11697 00AD  
Copyright © 2018 D&M Holdings Inc. All Rights Reserved.