

English	Français
<span></span>	
Name of each part	Nom de chaque élémén
Please confirm each part before using these headphones.	Vérifiez tous les composants avant d'utiliser les écouteurs.
<b>A</b> <ol style="list-style-type: none"><li>Headband</li> <li>LEFT/RIGHT</li> <li>Housing</li> <li>Earpad</li> <li>3.0 m cable</li> <li>6.3/3.5 mm gold-plated stereo 2-way plug</li> <li>Cable bushing for plug</li> <li>Joint</li> <li>Cable bushing for main unit</li></ol>	<b>A</b> <ol style="list-style-type: none"><li>Arceau</li> <li>GAUCHE/DROIT</li> <li>Boîtier</li> <li>Coussinets</li> <li>Câble 3,0 m</li> <li>Fiche stéréo deux points plaquée or φ 6,3/φ 3,5 mm</li> <li>Douille du cordon pour la prise</li> <li>Fixation de la coque</li> <li>Douille du cordon pour l'unité principale</li></ol>
<b>●</b> Wing support parts <ol style="list-style-type: none"><li>Head top base</li> <li>Headpad</li> <li>Wing arm</li></ol>	<b>●</b> Éléments des ailes de soutien <ol style="list-style-type: none"><li>Base supérieure de l'aile</li> <li>Coussinet pour la tête</li> <li>Bras de l'aile de support</li></ol>

### Using headphones

- Minimize the volume of each sound device, then connect the headphones to the headphone terminal.
- Please make sure to position the earpads correctly (LEFT/RIGHT position and with the earpad covering the whole ear).
- Turn on your audio device, and adjust volume as necessary.

\*Please also read instruction manual of audio device.

Headphones with a 3.5 mm stereo mini-plug and a 6.3 mm stereo plug adapter.

Headphones with a 3.5 mm stereo mini-plug and a 6.3 mm stereo plug adapter.

Headphones with a 3.5 mm stereo mini-plug and a 6.3 mm stereo plug adapter.

Headphones with a 3.5 mm stereo mini-plug and a 6.3 mm stereo plug adapter.

Headphones with a 3.5 mm stereo mini-plug and a 6.3 mm stereo plug adapter.

Headphones with a 3.5 mm stereo mini-plug and a 6.3 mm stereo plug adapter.

Headphones with a 3.5 mm stereo mini-plug and a 6.3 mm stereo plug adapter.

Headphones with a 3.5 mm stereo mini-plug and a 6.3 mm stereo plug adapter.

Headphones with a 3.5 mm stereo mini-plug and a 6.3 mm stereo plug adapter.

Headphones with a 3.5 mm stereo mini-plug and a 6.3 mm stereo plug adapter.

Headphones with a 3.5 mm stereo mini-plug and a 6.3 mm stereo plug adapter.

Headphones with a 3.5 mm stereo mini-plug and a 6.3 mm stereo plug adapter.

Headphones with a 3.5 mm stereo mini-plug and a 6.3 mm stereo plug adapter.

Headphones with a 3.5 mm stereo mini-plug and a 6.3 mm stereo plug adapter.

Headphones with a 3.5 mm stereo mini-plug and a 6.3 mm stereo plug adapter.

Headphones with a 3.5 mm stereo mini-plug and a 6.3 mm stereo plug adapter.

Headphones with a 3.5 mm stereo mini-plug and a 6.3 mm stereo plug adapter.

Headphones with a 3.5 mm stereo mini-plug and a 6.3 mm stereo plug adapter.

Headphones with a 3.5 mm stereo mini-plug and a 6.3 mm stereo plug adapter.

Headphones with a 3.5 mm stereo mini-plug and a 6.3 mm stereo plug adapter.

Headphones with a 3.5 mm stereo mini-plug and a 6.3 mm stereo plug adapter.

Headphones with a 3.5 mm stereo mini-plug and a 6.3 mm stereo plug adapter.

Headphones with a 3.5 mm stereo mini-plug and a 6.3 mm stereo plug adapter.

Headphones with a 3.5 mm stereo mini-plug and a 6.3 mm stereo plug adapter.

Headphones with a 3.5 mm stereo mini-plug and a 6.3 mm stereo plug adapter.

Headphones with a 3.5 mm stereo mini-plug and a 6.3 mm stereo plug adapter.

Headphones with a 3.5 mm stereo mini-plug and a 6.3 mm stereo plug adapter.

Headphones with a 3.5 mm stereo mini-plug and a 6.3 mm stereo plug adapter.

Headphones with a 3.5 mm stereo mini-plug and a 6.3 mm stereo plug adapter.

Headphones with a 3.5 mm stereo mini-plug and a 6.3 mm stereo plug adapter.

Headphones with a 3.5 mm stereo mini-plug and a 6.3 mm stereo plug adapter.

Headphones with a 3.5 mm stereo mini-plug and a 6.3 mm stereo plug adapter.

Headphones with a 3.5 mm stereo mini-plug and a 6.3 mm stereo plug adapter.

Headphones with a 3.5 mm stereo mini-plug and a 6.3 mm stereo plug adapter.

Headphones with a 3.5 mm stereo mini-plug and a 6.3 mm stereo plug adapter.

Headphones with a 3.5 mm stereo mini-plug and a 6.3 mm stereo plug adapter.

Headphones with a 3.5 mm stereo mini-plug and a 6.3 mm stereo plug adapter.

Headphones with a 3.5 mm stereo mini-plug and a 6.3 mm stereo plug adapter.

Headphones with a 3.5 mm stereo mini-plug and a 6.3 mm stereo plug adapter.

Headphones with a 3.5 mm stereo mini-plug and a 6.3 mm stereo plug adapter.

Headphones with a 3.5 mm stereo mini-plug and a 6.3 mm stereo plug adapter.

Headphones with a 3.5 mm stereo mini-plug and a 6.3 mm stereo plug adapter.

Headphones with a 3.5 mm stereo mini-plug and a 6.3 mm stereo plug adapter.

Headphones with a 3.5 mm stereo mini-plug and a 6.3 mm stereo plug adapter.

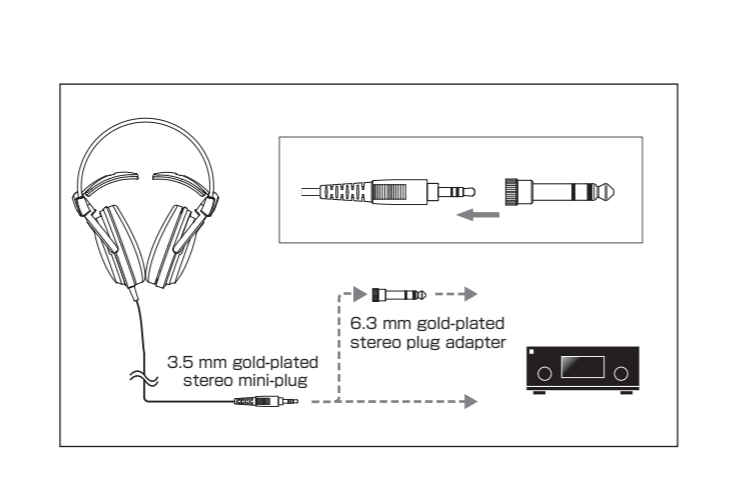

Deutsch	Italiano
<span></span>	
Namen der einzelnen Teile	Nome delle varie componenti
Überprüfen Sie vor dem Gebrauch der Kopfhörer die einzelnen Teile.	Prima di utilizzare le cuffie, verificare ogni componente.
<b>A</b> <ol style="list-style-type: none"><li>Kopfband</li> <li>LINKS/RECHTS</li> <li>Gehäuse</li> <li>Ohrpolster</li> <li>3,0 m langes Kabel</li> <li>φ6,3/φ3,5 mm vergoldeter 2-Wege-Stereostecker</li> <li>Kabelbuchse am Stecker</li> <li>Befestigungspunkt</li> <li>Kabelbuchse an der Hauptinheit</li></ol>	<b>A</b> <ol style="list-style-type: none"><li>Archetto da collo</li> <li>SINISTRA/DESTRA</li> <li>Innesti auricolari</li> <li>Cuscinetti auricolari</li> <li>3,0 m cavo</li> <li>Spinotto bidirezionale stereo dorato da φ6,3/φ3,5 mm</li> <li>Boccola di corda per spina elettrica</li> <li>Articolazione</li> <li>Boccola di corda per unità principale</li></ol>
<b>●</b> Bestandteile des Flügelsystems <ol style="list-style-type: none"><li>Hauptflügel</li> <li>Polsterung am Kopf</li> <li>Flügelarm</li></ol>	<b>●</b> Parti di appoggio di ala <ol style="list-style-type: none"><li>Base di cima di testa</li> <li>Poggiatesta</li> <li>Braccio di ala</li></ol>

### Benutzung der Kopfhörer

- Stellen Sie die Gerätelautstärke auf den niedrigsten Pegel und schließen Sie das Kabel an die Kopfhörerbuchse des Geräts an.
- Setzen Sie den Kopfhörer so auf, dass die „LEFT“-Seite auf dem linken Ohr und die „RIGHT“-Seite auf dem rechten Ohr sitzt, und passen Sie die Sitzform an, damit die Ohrpolster die gesamten Ohren bedecken.
- Stellen Sie das angeschlossene Gerät auf Wiedergabe und passen Sie die Lautstärke an.

\*Bitte lesen Sie auch das Handbuch des Gerätes, das Sie anschließen möchten.

Headphones with a 3.5 mm stereo mini-plug and a 6.3 mm stereo plug adapter.

Headphones with a 3.5 mm stereo mini-plug and a 6.3 mm stereo plug adapter.

Headphones with a 3.5 mm stereo mini-plug and a 6.3 mm stereo plug adapter.

Headphones with a 3.5 mm stereo mini-plug and a 6.3 mm stereo plug adapter.

Headphones with a 3.5 mm stereo mini-plug and a 6.3 mm stereo plug adapter.

Headphones with a 3.5 mm stereo mini-plug and a 6.3 mm stereo plug adapter.

Headphones with a 3.5 mm stereo mini-plug and a 6.3 mm stereo plug adapter.

Headphones with a 3.5 mm stereo mini-plug and a 6.3 mm stereo plug adapter.

Headphones with a 3.5 mm stereo mini-plug and a 6.3 mm stereo plug adapter.

Headphones with a 3.5 mm stereo mini-plug and a 6.3 mm stereo plug adapter.

Headphones with a 3.5 mm stereo mini-plug and a 6.3 mm stereo plug adapter.

Headphones with a 3.5 mm stereo mini-plug and a 6.3 mm stereo plug adapter.

Headphones with a 3.5 mm stereo mini-plug and a 6.3 mm stereo plug adapter.

Headphones with a 3.5 mm stereo mini-plug and a 6.3 mm stereo plug adapter.

Headphones with a 3.5 mm stereo mini-plug and a 6.3 mm stereo plug adapter.

Headphones with a 3.5 mm stereo mini-plug and a 6.3 mm stereo plug adapter.

Headphones with a 3.5 mm stereo mini-plug and a 6.3 mm stereo plug adapter.

Headphones with a 3.5 mm stereo mini-plug and a 6.3 mm stereo plug adapter.

Headphones with a 3.5 mm stereo mini-plug and a 6.3 mm stereo plug adapter.

Headphones with a 3.5 mm stereo mini-plug and a 6.3 mm stereo plug adapter.

Headphones with a 3.5 mm stereo mini-plug and a 6.3 mm stereo plug adapter.

Headphones with a 3.5 mm stereo mini-plug and a 6.3 mm stereo plug adapter.

Headphones with a 3.5 mm stereo mini-plug and a 6.3 mm stereo plug adapter.

Headphones with a 3.5 mm stereo mini-plug and a 6.3 mm stereo plug adapter.

Headphones with a 3.5 mm stereo mini-plug and a 6.3 mm stereo plug adapter.

Headphones with a 3.5 mm stereo mini-plug and a 6.3 mm stereo plug adapter.

Headphones with a 3.5 mm stereo mini-plug and a 6.3 mm stereo plug adapter.

Headphones with a 3.5 mm stereo mini-plug and a 6.3 mm stereo plug adapter.

Headphones with a 3.5 mm stereo mini-plug and a 6.3 mm stereo plug adapter.

Headphones with a 3.5 mm stereo mini-plug and a 6.3 mm stereo plug adapter.

Headphones with a 3.5 mm stereo mini-plug and a 6.3 mm stereo plug adapter.

Headphones with a 3.5 mm stereo mini-plug and a 6.3 mm stereo plug adapter.

Headphones with a 3.5 mm stereo mini-plug and a 6.3 mm stereo plug adapter.

Headphones with a 3.5 mm stereo mini-plug and a 6.3 mm stereo plug adapter.

Headphones with a 3.5 mm stereo mini-plug and a 6.3 mm stereo plug adapter.

Headphones with a 3.5 mm stereo mini-plug and a 6.3 mm stereo plug adapter.

Headphones with a 3.5 mm stereo mini-plug and a 6.3 mm stereo plug adapter.

Headphones with a 3.5 mm stereo mini-plug and a 6.3 mm stereo plug adapter.

Headphones with a 3.5 mm stereo mini-plug and a 6.3 mm stereo plug adapter.

Headphones with a 3.5 mm stereo mini-plug and a 6.3 mm stereo plug adapter.

Headphones with a 3.5 mm stereo mini-plug and a 6.3 mm stereo plug adapter.

Headphones with a 3.5 mm stereo mini-plug and a 6.3 mm stereo plug adapter.

Español	Português
<span></span>	
Nombre de cada pieza	Nome de cada parte
Confirme cada pieza antes de utilizar estos auriculares.	Favor confirmar cada parte antes de utilizar estes fones de ouvido.
<b>A</b> <ol style="list-style-type: none"><li>Banda posterior</li> <li>IZQUIERDA/DERECHA</li> <li>Carcasa</li> <li>Almohadilla para los oídos</li> <li>Cable de 3,0 m</li> <li>Clavija doble estéreo chapada en oro de φ6,3/φ3,5 mm</li> <li>Buje de cable para el enchufe</li> <li>Articulación</li> <li>Buje de cable para unidad principal</li></ol>	<b>A</b> <ol style="list-style-type: none"><li>Alça</li> <li>ESQUERDA/DIREITA</li> <li>Encaixe</li> <li>Almofada</li> <li>Fio de 3,0 m</li> <li>Plugue estéreo bidirecional de φ6,3/φ3,5 mm dourado</li> <li>Casquilho do fio para plugue</li> <li>Ligação</li> <li>Casquilho do fio para unidade principal</li></ol>
<b>●</b> Partes de soporte de ala <ol style="list-style-type: none"><li>Base para alto da cabeça</li> <li>Apoyacabeza</li> <li>Brazo de ala</li></ol>	<b>●</b> Partes do suporte de asa <ol style="list-style-type: none"><li>Base para alto da cabeça</li> <li>Almofada para cabeça</li> <li>Braço da asa</li></ol>

### Usando auriculares

- Gire el volumen del dispositivo al mínimo y conecte el cable al conector de auricular del dispositivo.
- Coloque los auriculares sobre la cabeza de modo que el lado "LEFT" esté sobre el oído izquierdo y el lado "RIGHT" esté sobre el oído derecho y ajústelos de modo que las almohadillas cubran toda la oreja.
- Encienda el dispositivo que esté conectado y ajuste el volumen a su gusto.

\*Lea también el manual de instrucciones del dispositivo que vaya a conectar, por favor.

Headphones with a 3.5 mm stereo mini-plug and a 6.3 mm stereo plug adapter.

Headphones with a 3.5 mm stereo mini-plug and a 6.3 mm stereo plug adapter.

Headphones with a 3.5 mm stereo mini-plug and a 6.3 mm stereo plug adapter.

Headphones with a 3.5 mm stereo mini-plug and a 6.3 mm stereo plug adapter.

Headphones with a 3.5 mm stereo mini-plug and a 6.3 mm stereo plug adapter.

Headphones with a 3.5 mm stereo mini-plug and a 6.3 mm stereo plug adapter.

Headphones with a 3.5 mm stereo mini-plug and a 6.3 mm stereo plug adapter.

Headphones with a 3.5 mm stereo mini-plug and a 6.3 mm stereo plug adapter.

Headphones with a 3.5 mm stereo mini-plug and a 6.3 mm stereo plug adapter.

Headphones with a 3.5 mm stereo mini-plug and a 6.3 mm stereo plug adapter.

Headphones with a 3.5 mm stereo mini-plug and a 6.3 mm stereo plug adapter.

Headphones with a 3.5 mm stereo mini-plug and a 6.3 mm stereo plug adapter.

Headphones with a 3.5 mm stereo mini-plug and a 6.3 mm stereo plug adapter.

Headphones with a 3.5 mm stereo mini-plug and a 6.3 mm stereo plug adapter.

Headphones with a 3.5 mm stereo mini-plug and a 6.3 mm stereo plug adapter.

Headphones with a 3.5 mm stereo mini-plug and a 6.3 mm stereo plug adapter.

Headphones with a 3.5 mm stereo mini-plug and a 6.3 mm stereo plug adapter.

Headphones with a 3.5 mm stereo mini-plug and a 6.3 mm stereo plug adapter.

Headphones with a 3.5 mm stereo mini-plug and a 6.3 mm stereo plug adapter.

Headphones with a 3.5 mm stereo mini-plug and a 6.3 mm stereo plug adapter.

Headphones with a 3.5 mm stereo mini-plug and a 6.3 mm stereo plug adapter.

Headphones with a 3.5 mm stereo mini-plug and a 6.3 mm stereo plug adapter.

Headphones with a 3.5 mm stereo mini-plug and a 6.3 mm stereo plug adapter.

Headphones with a 3.5 mm stereo mini-plug and a 6.3 mm stereo plug adapter.

Headphones with a 3.5 mm stereo mini-plug and a 6.3 mm stereo plug adapter.

Headphones with a 3.5 mm stereo mini-plug and a 6.3 mm stereo plug adapter.

Headphones with a 3.5 mm stereo mini-plug and a 6.3 mm stereo plug adapter.

Headphones with a 3.5 mm stereo mini-plug and a 6.3 mm stereo plug adapter.

Headphones with a 3.5 mm stereo mini-plug and a 6.3 mm stereo plug adapter.

Headphones with a 3.5 mm stereo mini-plug and a 6.3 mm stereo plug adapter.

Headphones with a 3.5 mm stereo mini-plug and a 6.3 mm stereo plug adapter.

Headphones with a 3.5 mm stereo mini-plug and a 6.3 mm stereo plug adapter.

Headphones with a 3.5 mm stereo mini-plug and a 6.3 mm stereo plug adapter.

Headphones with a 3.5 mm stereo mini-plug and a 6.3 mm stereo plug adapter.

Headphones with a 3.5 mm stereo mini-plug and a 6.3 mm stereo plug adapter.

Headphones with a 3.5 mm stereo mini-plug and a 6.3 mm stereo plug adapter.

Headphones with a 3.5 mm stereo mini-plug and a 6.3 mm stereo plug adapter.

Headphones with a 3.5 mm stereo mini-plug and a 6.3 mm stereo plug adapter.

Headphones with a 3.5 mm stereo mini-plug and a 6.3 mm stereo plug adapter.

Headphones with a 3.5 mm stereo mini-plug and a 6.3 mm stereo plug adapter.

Headphones with a 3.5 mm stereo mini-plug and a 6.3 mm stereo plug adapter.

Headphones with a 3.5 mm stereo mini-plug and a 6.3 mm stereo plug adapter.

Headphones with a 3.5 mm stereo mini-plug and a 6.3 mm stereo plug adapter.

Headphones with a 3.5 mm stereo mini-plug and a 6.3 mm stereo plug adapter.

Headphones with a 3.5 mm stereo mini-plug and a 6.3 mm stereo plug adapter.

Headphones with a 3.5 mm stereo mini-plug and a 6.3 mm stereo plug adapter.

Headphones with a 3.5 mm stereo mini-plug and a 6.3 mm stereo plug adapter.

Headphones with a 3.5 mm stereo mini-plug and a 6.3 mm stereo plug adapter.

Headphones with a 3.5 mm stereo mini-plug and a 6.3 mm stereo plug adapter.

Headphones with a 3.5 mm stereo mini-plug and a 6.3 mm stereo plug adapter.

Headphones with a 3.5 mm stereo mini-plug and a 6.3 mm stereo plug adapter.

Headphones with a 3.5 mm stereo mini-plug and a 6.3 mm stereo plug adapter.

Headphones with a 3.5 mm stereo mini-plug and a 6.3 mm stereo plug adapter.

Headphones with a 3.5 mm stereo mini-plug and a 6.3 mm stereo plug adapter.

Headphones with a 3.5 mm stereo mini-plug and a 6.3 mm stereo plug adapter.

Headphones with a 3.5 mm stereo mini-plug and a 6.3 mm stereo plug adapter.

Headphones with a 3.5 mm stereo mini-plug and a 6.3 mm stereo plug adapter.

Headphones with a 3.5 mm stereo mini-plug and a 6.3 mm stereo plug adapter.

Headphones with a 3.5 mm stereo mini-plug and a 6.3 mm stereo plug adapter.

Headphones with a 3.5 mm stereo mini-plug and a 6.3 mm stereo plug adapter.

Headphones with a 3.5 mm stereo mini-plug and a 6.3 mm stereo plug adapter.

Headphones with a 3.5 mm stereo mini-plug and a 6.3 mm stereo plug adapter.

Headphones with a 3.5 mm stereo mini-plug and a 6.3 mm stereo plug adapter.

Headphones with a 3.5 mm stereo mini-plug and a 6.3 mm stereo plug adapter.

Headphones with a 3.5 mm stereo mini-plug and a 6.3 mm stereo plug adapter.

Русский	한국어
<span></span>	
Название каждой детали	각부 명칭
<b>Ознакомьтесь с каждой деталью перед использованием наушников.</b>	이 헤드폰을 사용하기 전에 각 부분을 확인하십시오.
<b>A</b> <ol style="list-style-type: none"><li>Стяжка</li> <li>ЛЕВЫЙ/ПРАВЫЙ</li> <li>Корпус</li> <li>Подушечка</li> <li>Кабель 3,0 м</li> <li>φ6,3/φ3,5 мм, 2-канальный стерео-разъём с позолоченными контактами</li> <li>Втулка шнура для штекера</li> <li>Соединение</li> <li>Втулка шнура для главного блока</li></ol>	<b>A</b> <ol style="list-style-type: none"><li>헤드밴드</li> <li>왼쪽/오른쪽</li> <li>하우징</li> <li>이어패드</li> <li>3.0 m 케이블</li> <li>φ6.3/φ3.5 mm 금도금 스테레오 2-웨이 플러그</li> <li>플러그 케이블 부싱</li> <li>조인트</li> <li>본체 케이블 부싱</li></ol>
<b>●</b> Детали оголовья <ol style="list-style-type: none"><li>Опора для макушки</li> <li>Подушечка для головы</li> <li>Кронштейн оголовья</li></ol>	<b>●</b> 원서포트 각부의 명칭 <ol style="list-style-type: none"><li>헤드 톱 베이스</li> <li>헤드 패드</li> <li>원암</li></ol>

### Использование наушников

- Уменьшите громкость каждого звукового устройства до минимума, после чего подключите наушники к гнезду для наушников.
- Правильно выставьте положение амбушуров (положение ЛЕВЫЙ/ПРАВЫЙ, чтобы амбушюр закрывал все ухо).
- Включите аудиоустройство и выставьте громкость на необходимый уровень.

\*Пожалуйста, ознакомьтесь также с инструкцией по эксплуатации аудиоустройства.

Headphones with a 3.5 mm stereo mini-plug and a 6.3 mm stereo plug adapter.

Headphones with a 3.5 mm stereo mini-plug and a 6.3 mm stereo plug adapter.

Headphones with a 3.5 mm stereo mini-plug and a 6.3 mm stereo plug adapter.

Headphones with a 3.5 mm stereo mini-plug and a 6.3 mm stereo plug adapter.

Headphones with a 3.5 mm stereo mini-plug and a 6.3 mm stereo plug adapter.

Headphones with a 3.5 mm stereo mini-plug and a 6.3 mm stereo plug adapter.

Headphones with a 3.5 mm stereo mini-plug and a 6.3 mm stereo plug adapter.

Headphones with a 3.5 mm stereo mini-plug and a 6.3 mm stereo plug adapter.

Headphones with a 3.5 mm stereo mini-plug and a 6.3 mm stereo plug adapter.

Headphones with a 3.5 mm stereo mini-plug and a 6.3 mm stereo plug adapter.

Headphones with a 3.5 mm stereo mini-plug and a 6.3 mm stereo plug adapter.

Headphones with a 3.5 mm stereo mini-plug and a 6.3 mm stereo plug adapter.

Headphones with a 3.5 mm stereo mini-plug and a 6.3 mm stereo plug adapter.

Headphones with a 3.5 mm stereo mini-plug and a 6.3 mm stereo plug adapter.

Headphones with a 3.5 mm stereo mini-plug and a 6.3 mm stereo plug adapter.

Headphones with a 3.5 mm stereo mini-plug and a 6.3 mm stereo plug adapter.