

# ALLEN & HEATH

Allen & Heath Limited  
 Kernick Industrial Estate  
 Penryn, Cornwall,  
 TR10 9LU, UK  
[www.allen-heath.com](http://www.allen-heath.com)

## DT164-W Technical Datasheet

### Overview

- Designed for Wall Mount or Dip Trap installation
- 16 Mic Preamps on XLR
- Phantom Power LED per Input
- 4 XLR Line Outs
- DANTE Primary connection with locking Ethercon port
- DANTE Secondary locking Ethercon port for daisy chaining or redundancy

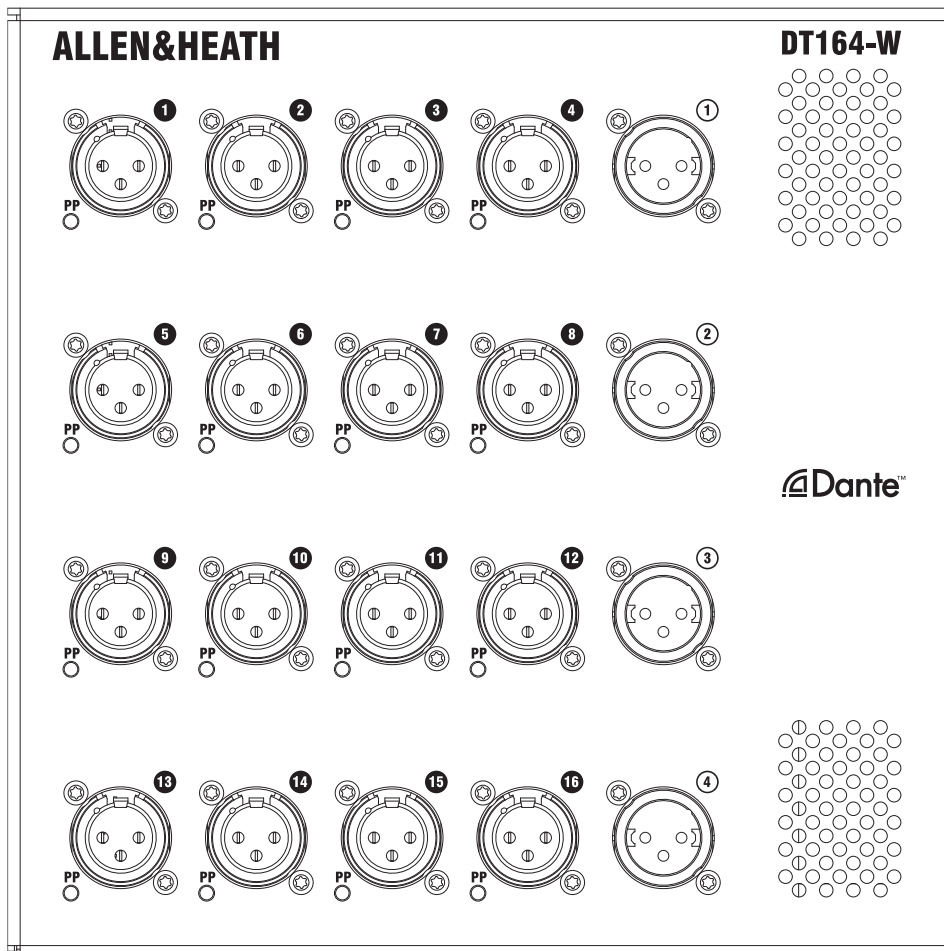
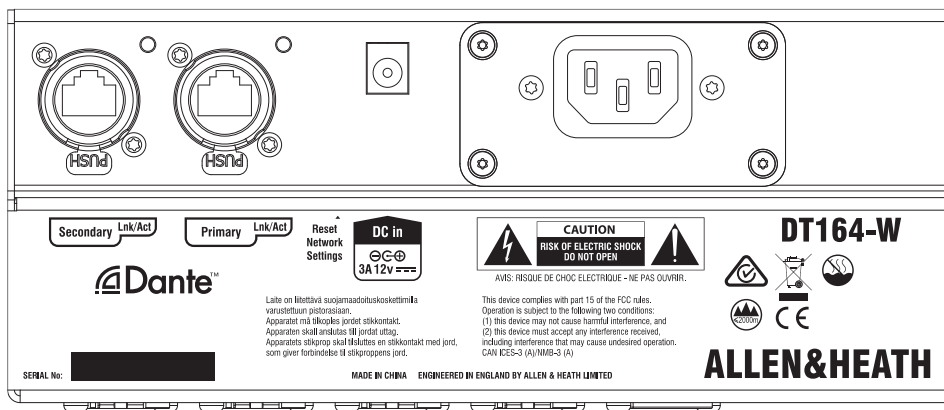

## Dimensions

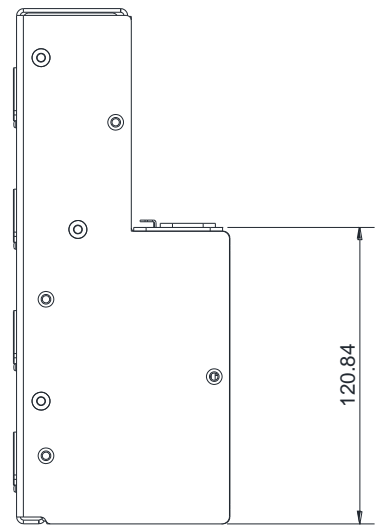
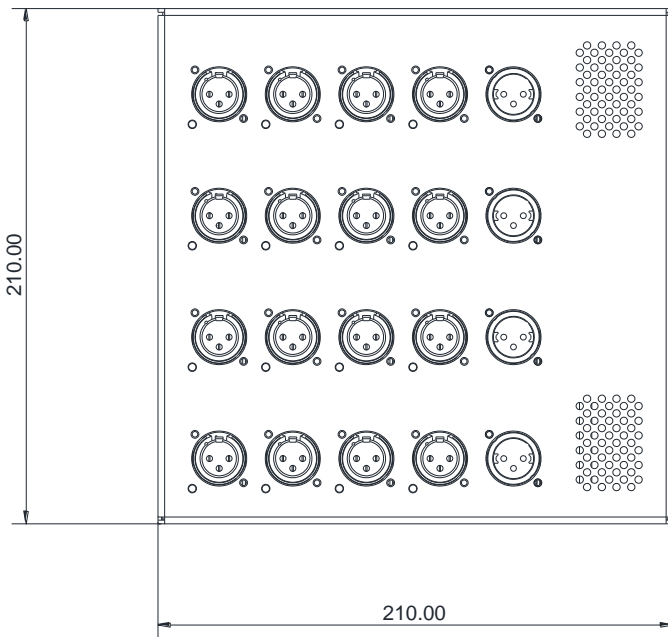
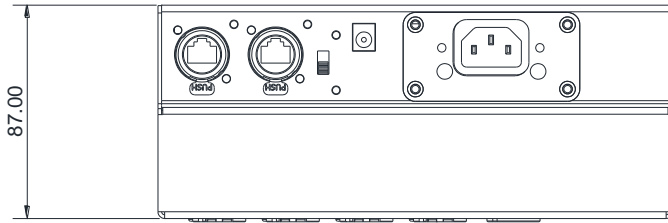

## A&E Specifications

The unit shall be a remote audio device for Dante enabled Allen & Heath mixing systems. The remote audio unit shall provide 16 XLR inputs with individually configured Phantom Power and 4 XLR outputs. Phantom power LED indicators shall be provided per input socket on the unit. The unit shall be able to provide 48kHz or 96kHz sample rate on a Dante network.

Two Neutrik Ethercon link connectors shall be provided for transport of the digital audio and control signals over Dante. The unit shall be able to operate in 'redundant' or 'switched' mode by means of software. In 'redundant' mode the unit shall provide full redundant connection to any Dante enabled device. In 'switch' mode the unit shall allow daisy chained connection of multiple units. The unit shall have a hardware "Network reset" switch.

The Ethernet protocol shall provide control to the remote preamp, and all mic preamps shall be recallable by the mixing system.

The remote audio unit shall have a robust steel chassis and shall be designed to be placed in different mounting options including NEMA12x12" box, horizontally or vertically, flush or straight mount.

The remote audio unit shall have a built-in power supply accepting AC mains voltages of 100~240V, 50/60 Hz, 40W max via an earthed 3-pin IEC male connector or an optional screw terminal with cable gland mounted on the rear chassis. A 12V DC input shall be provided for use as primary power supply or redundant power supply.

Recommended operating temperature for the remote audio unit shall be 0 to 40 degrees Celsius.

The unit shall be the Allen & Heath DT164-W.

## System Specifications

<b>Mic/Line XLR Inputs</b>	Balanced XLR, +48V phantom power
Mic/Line Preamp	Fully recallable
Input Sensitivity	-60 to +15dBu
Analogue Gain	+5 to +60dB, 1dB steps
Pad	-20dB Active PAD
Maximum Input Level	+30dBu (PAD in)
Input Impedance	>4k $\Omega$ (Pad out), >10k $\Omega$ (Pad in)
Mic EIN	-127dB with 150 $\Omega$ source
<b>Analogue XLR Outputs</b>	Balanced, Relay protected
Output Impedance	<75 $\Omega$
Nominal Output	+4dBu = 0dB meter reading
Maximum Output Level	+22dBu
Residual Output Noise	-92dBu (muted, 20-20kHz) -90dBu (muted, 20-40kHz)
<b>Dante</b>	
Sample rate	48kHz or 96kHz
Bit Depth	24 Bit
Gain, Pad, 48v Control	Allen & Heath dLive, Avantis, AHM-64 or SQ system
<b>Operating Temperature Range</b>	0°C to 40°C (32°F to 104°F)
<b>Power</b>	
Mains Voltage Operating Range	100-240V AC, 50/60Hz
Mains Power Consumption	40W max
DC Input	12V DC, 3A max
<b>Dimensions and Weight</b>	<i>Width x Depth x Height x Weight</i>
DT164-W	210 x 87 x 210 mm x 3.2kg (8.25" x 3.5" x 8.25" x 7lbs)